

BCT2

Exploded parts diagram

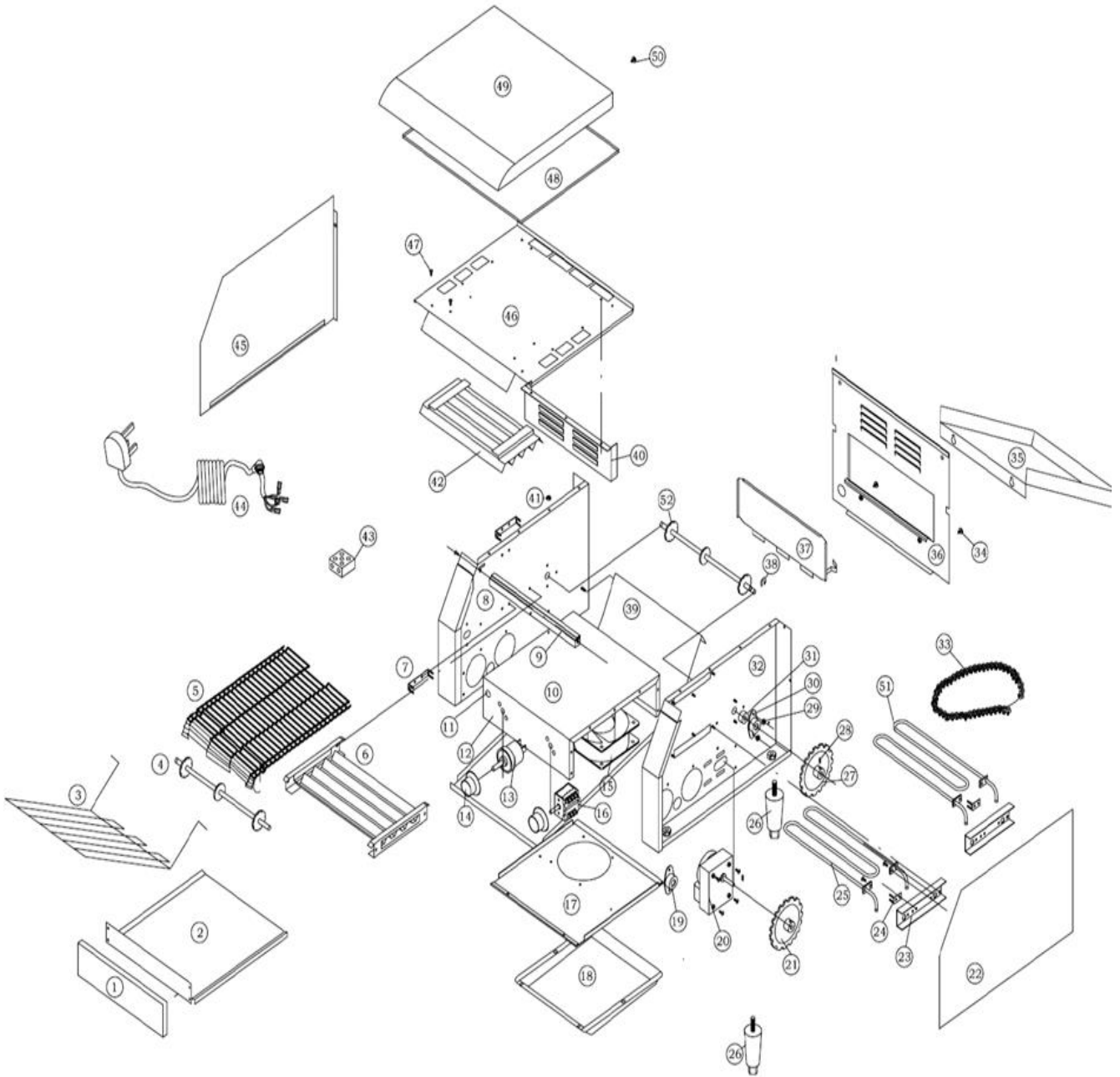





Part Number	Number	Description	Qty
***	1	Feed Ramp	1
***	2	Feed Ramp Tray	1
***	3	Wire Rack	1
***	4	Transmitting Wheel	1
***	5	Chain Protection Wire	1
***	6	Heating Element Lower Protection	1
***	7	Heating Element Left Support	2
***	8	Left Inner Panel	1
***	9	Front Beam	1
***	10	Lower Inner Panel	1
***	11	Power Indicator Light	1
***	12	Front Panel	1
B3-ZCT1013	13	Capacitor	1
B3-ZCT1014	14	Thermostat Knob	2
***	15	Fan	1
B3-ZCT016	16	3 Way Switch	1
***	17	Lower Air Vent Insulating Panel	1
***	18	Lower Air Vent	1
***	19	Front Bearing Cover Housing	2
B3-ZCT1020	20	Electric Motor	1
B3-ZCT1021	21	Electric Motor Chain Gear	1
***	22	Right Side Panel	1
***	23	Heating Element Housing Panel	2
***	24	Heating Element Right Support	2
B3-ZCT1025	25	Heating Element Lower	1
B3-ZCT1026	26	Adjustable Foot	1
B3-ZCT1027	27	Chain Gear	1
***	28	Top Rivet	2
***	29	Nut	10
***	30	Rear Bearing Cover Housing	2
***	31	Bearing Cover	4
***	32	Right Inner Panel	1
***	33	Chain	1
***	34	Hook Pin	2
***	35	Rear Receiving Tray	1
***	36	Rear Panel	1
***	37	Rear Slide Panel	1
***	38	Stop Spring	2
***	39	Slide Panel	1
***	40	Ventilation Panel	1
***	41	Nut	1
***	42	Heating Element Protection Cover	1
***	43	Power Plug	1
***	44	Power Cord	1
***	45	Right Side Panel	1

***	46	Top Inner Panel	1
***	47	Screw	61
***	48	Top Insulation Panel	1
***	49	Top Cover	1
***	50	Screw	1
B3-ZCT1051	51	Heating Element Upper	1
***	52	Driving Wheel	1

*** Please contact Spares for assistance ***