

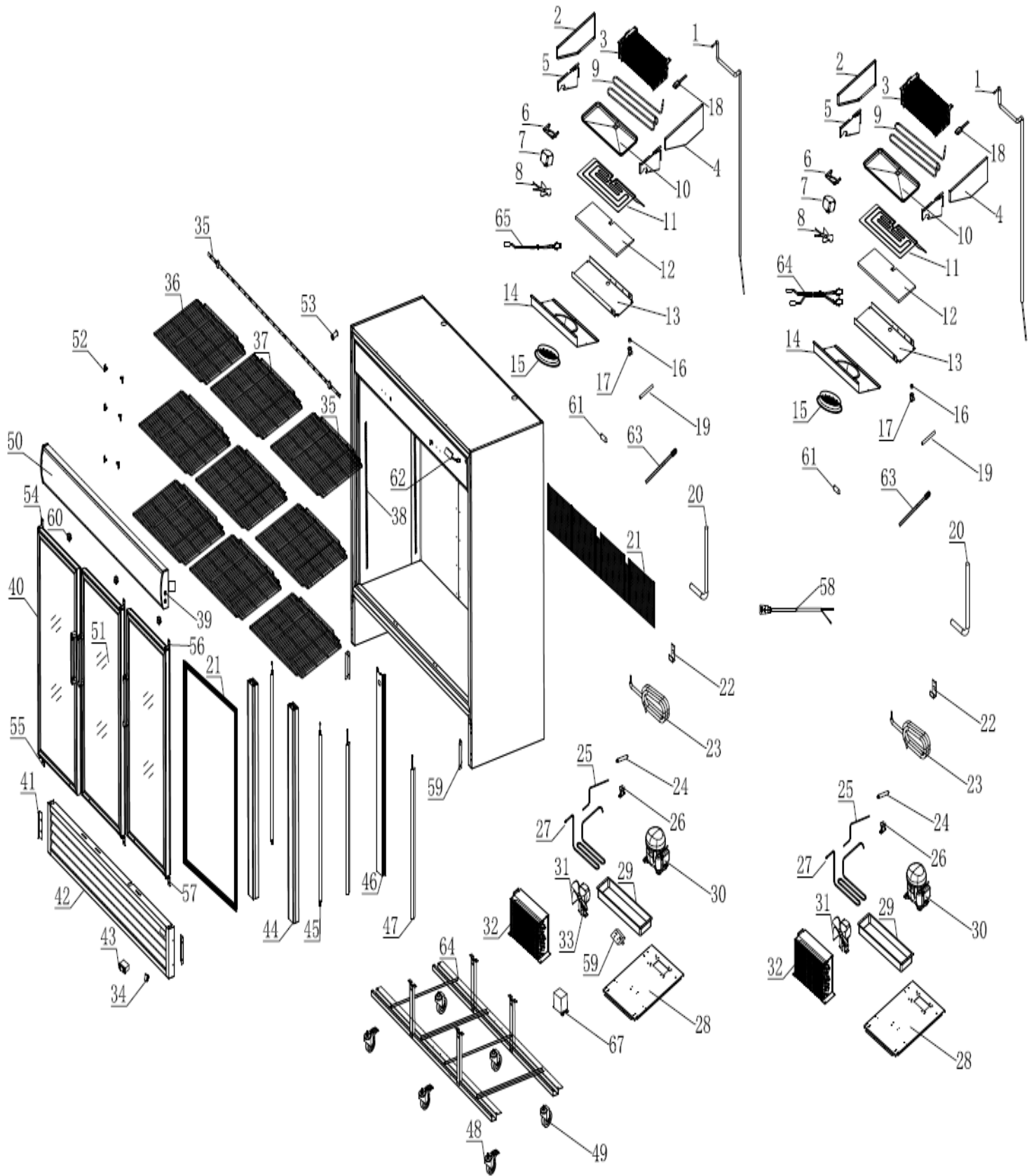

GDF1800

Exploded parts diagram

Sliding door image shown with reference to parts for the hinged versions





Part Number	Number	Description	Qty
B9-GDFCAP01	1	Capillary c/w Suction Pipe	2
***	2	Plate – Left	2
B9-GDFEVAP01	3	Evaporator	2
***	4	Plate – Right	2
***	5	Baffle Plate	4
***	6	Evap Fan Fixing Plate	2
B9-GDFEVAPFAN	7	Evaporator Fan Motor	2
B9-GDFEVAPBLADE	8	Evaporator Fan Blade	2
B9-GDFHEATER01	9	Defrost Heater	2
B9-GDFTRAY01	10	Evaporator Drip Tray	2
B9-GDFHEATER02	11	Evap Drip Tray Heater	2
***	12	Insulation	2
***	13	Fan Casing Back	2
***	14	Fan Casing Front	2
***	15	Fan Guard	2
B9-GDFSPIGOT	16	Drain Spigot	2
B9-GDFSPIGNUT	17	Drain Spigot Nut	2
B9-GDFLIMIT	18	Heat Limit Protector (Defrost)	2
***	19	Drainpipe	2
B9-GDFDRAIN	20	Drainpipe	2
***	21	Rear Grille	1
***	22	Pipe Fixing	1
***	23	Suction Pipe	2
***	24	Drier	2
***	25	Pipework	2
***	26	Fixing Bracket	2
***	27	Vaporising Coil	2
***	28	Unit Base	2
B9-GDFVAPTRAY03	29	Vaporising Tray	2
B9-GDFCOMP03	30	Compressor	2
B9-GDFCONDBLADE	31	Condenser Fan Blade	2
B9-GDFCONDFAN	32	Condenser Fan Motor	2
B9-GDFCOND	33	Condenser	2
B9-SWITCH	34	Mains Switch	1
B9-GDFSHELF04	35	Shelf RH	4
B9-GDFSHELF05	36	Shelf LH	4
B9-GDFSHELF06	37	Shelf Centre	4
***	38	Ladder Rack	12
B9-GDFSWITCH01	39	Light Switch (Red)	2
B9-GDFDOOR02	40	Door LH	1
***	41	Fixing Plate	1
B9-GDFPANEL03	42	Front Grille Panel	1

B9-GDFCONTROL	43	Controller	1
***	44	Mullion	2
B9-GFDLED04	45	Internal Centre LED	2
***	46	Press Pate	2
B9-GFDLED02	47	Internal Side LED	2
B9-GDFCASTOR01	48	Braked Castor	4
B9-GDFCASTOR02	49	Unbraked Castor	4
B9-GDFCANOPY03	50	Light Canopy	1
B9-GDFDOOR01	51	Door RH	2
K8-SHELFCLIPN	52	Fixings	48
***	53	Pressure Relief Valve	1
B9-GDFHINGE03	54	Top Hinge Left	1
B9-GDFHINGE04	55	Bottom Hinge Left	1
B9-GDFHINGE01	56	Top Hinge Right	2
B9-GDFHINGE02	57	Bottom Hinge Right	2
***	58	Power Cord	1
B9-GDFRELAY03	59	Relay	2
B9-GDFFANSWITCH	60	Fan Switch	3
***	61	Sensor Cover	1
B9-GDFDRIVER03	62	Led Driver	1
B9-GDFDRAINHEAT	63	Drain Heater	1
N/A	64	N/A	N/A
B9-GDFSENSOR	65	Temperature Sensor	1
B9-GDFLOCK	N/A	Lock c/w Key	1

*** Please contact Spares for assistance ***